

# 53034

## Datasheet

# FULBAT™

## MOTORCYCLE BATTERY



**GEL**

**NON-SPILLABLE**

GEL battery range is designed to offer maximum performance and safety! Ready to use, GEL battery will not require any acid handling, initial preparation or maintenance. The non-spillable design (VRLA) linked to its high performance make it the ideal battery for all powersports.

### SPECIFICATIONS

| Voltage    | Capacity             | CCA (EN)    |
|------------|----------------------|-------------|
| <b>12V</b> | <b>31.6Ah</b> (20hr) | <b>300A</b> |
|            | <b>30.0Ah</b> (10hr) |             |

### DIMENSIONS & WEIGHT

|              |         |
|--------------|---------|
| Length       | 178±2mm |
| Width        | 123±2mm |
| Total Height | 166±2mm |
| Gross weight | 8.52kg  |

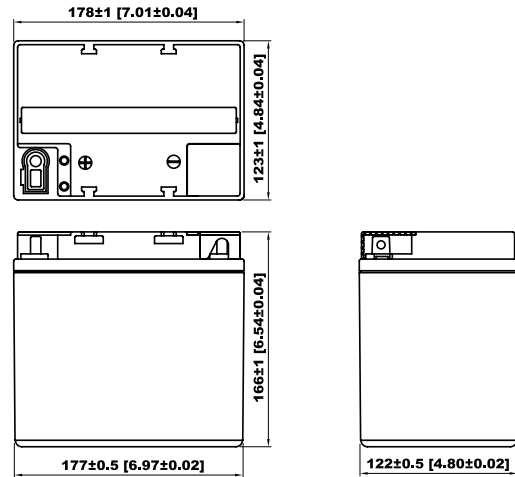

### FEATURES

- GEL technology
- Ready to use
- VRLA battery
- Non spillable: easy to ship
- 100% maintenance free
- Multi-positional fitment
- Suitable for cold weather
- No acid handling
- Easy to install
- Increased life time

### POLARITY



### MOUNTING ANGLES

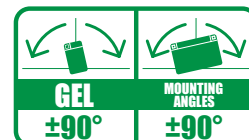

### TERMINAL

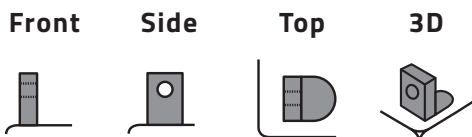

### APPLICATIONS

